

REVIEW: Area

Name _____

Key Concept and Vocabulary

Rectangle: $A = bh$

Parallelogram: $A = bh$

Triangle: $A = \frac{1}{2}bh$

Trapezoid: $A = \frac{1}{2}(B + b)h$



Visual Model

Area of a Rectangle:

$$A = bh$$

$$= (12)(10)$$

$$= 120 \text{ square units}$$

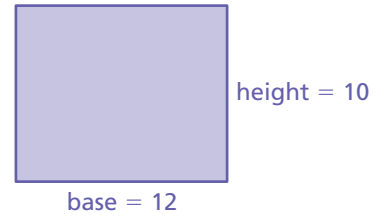

Skill Examples

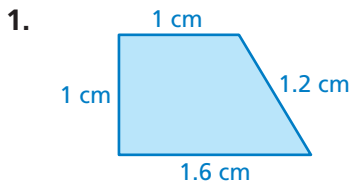

$$A = \frac{1}{2}(1.6 + 1)(1)$$

$$= 1.3 \text{ cm}^2$$

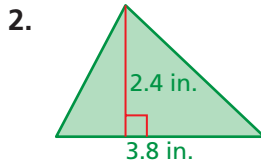

$$A = \frac{1}{2}(3.8)(2.4)$$

$$= 4.56 \text{ in.}^2$$

Application Example

3. Find the area of the apartment.

$$A = 60 \cdot 40$$

$$= 2400 \text{ ft}^2$$

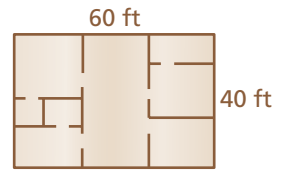

∴ The area is 2400 square feet.

PRACTICE MAKES PURR-FECT™



Check your answers at BigIdeasMath.com.

Find the area of the figure.

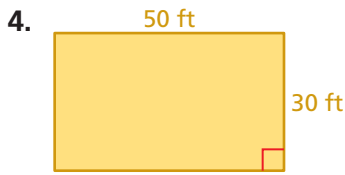

Area = _____

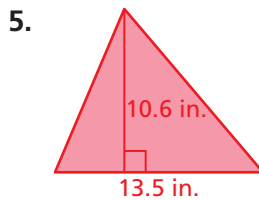

Area = _____

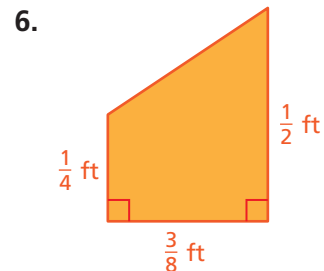

Area = _____

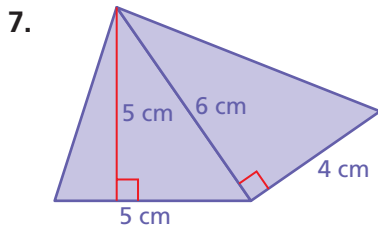

Area = _____

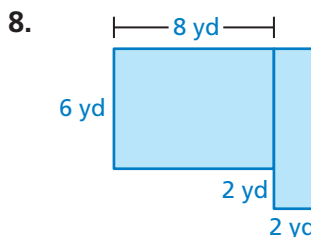

Area = _____

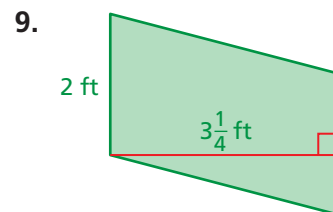

Area = _____

10. **CARPET** You are carpeting a rectangular room that is 3.5 yards by 4.5 yards. The carpet costs \$15 per square yard. How much will it cost to carpet the room? _____

11. **COLORADO** Colorado is approximately a rectangle that is 280 miles by 380 miles. Is the area of Colorado greater than or less than 100,000 square miles? Explain.
